

PERRYVILLE INDUSTRIAL PARK

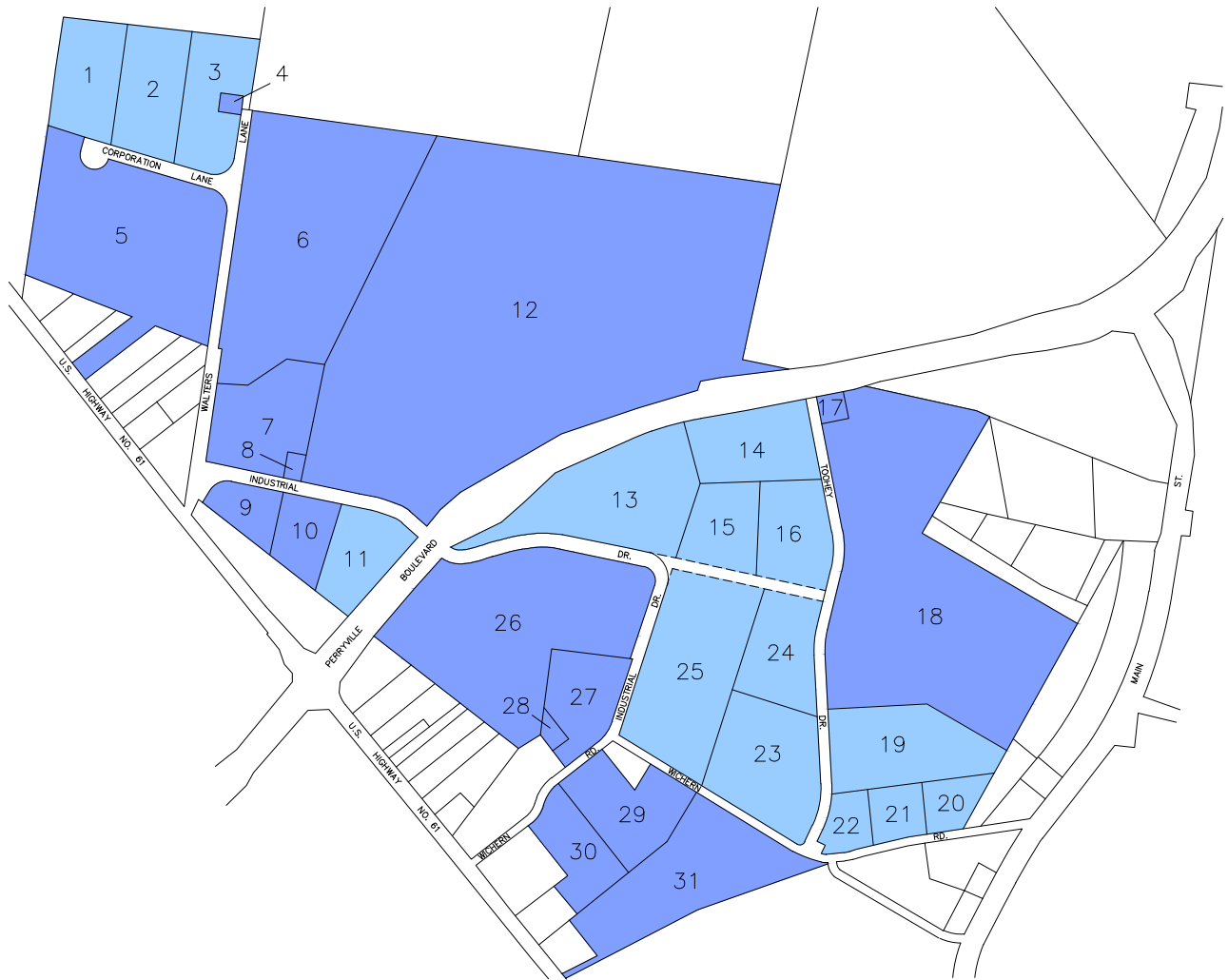

- | | | | | | |
|----|---------------------------------------|----|------------------|----|------------------------------------|
| 1 | Vacant ±5.2 Ac. | 11 | Vacant ±4.3 Ac. | 23 | Vacant ±8.6 Ac. |
| 2 | Vacant ±5.7 Ac. | 12 | TG Missouri | 24 | Vacant ±5.3 Ac. |
| 3 | Vacant ±5.7 Ac. | 13 | Vacant ±11.2 Ac. | 25 | Vacant ±12.3 Ac. |
| 4 | American Telephone & Telegraph Co. | 14 | Vacant ±6.1 Ac. | 26 | Falcon Foam |
| 5 | Solar Communications | 15 | Vacant ±4.1 Ac. | 27 | TNT Plastics |
| 6 | Robinson Construction | 16 | Vacant ±5.0 Ac. | 28 | Sutterer Oil Co. |
| 7 | TG Missouri Receiving | 17 | City Water Tower | 29 | Perry County Sheltered Workshop |
| 8 | City Water Tower | 18 | Gilster-Mary Lee | 30 | Loness Machine Shop |
| 9 | MFA Oil Co. | 19 | Vacant ±8.5 Ac. | 31 | Gilster-Mary Lee |
| 10 | Citizens Electric Substation | 20 | Vacant ±1.9 Ac. | | |
| | | 21 | Vacant ±2.0 Ac. | | |
| | | 22 | Vacant ±1.8 Ac. | | |

